



\*Not For Use With Potable Drinking Water Applications

## VALVES

SWING CHECK - BRASS  
200 WOG/CWP

### FEATURES & APPLICATIONS:

- 200 WOG/CWP
- Body; Brass
- Disc; Brass
- Female x Female NPT
- For fluid traveling only in one direction

### TECHNICAL DATA:

- **WOG** = Rating indicates the maximum non-shock pressure at ambient temperatures at which the valve may be used.
- **CWP** = Cold working pressure

**WOG:** Water, Oil & Gas: This was an older, generic pressure rating call-out which has been largely replaced by CWP. In this designation, "GAS" refers to any non-flammable, compressible fluid in a gaseous state. It does not imply a product's suitability or third-party approval for use with flammable gases. Similarly, in this designation, "Oil" does not imply a product's third-party approval for use with any petroleum products.

BRASS	
Size	Part #
1/2"	SC 050
3/4"	SC 075
1"	SC 100
1-1/4"	SC 125
1-1/2"	SC 150
2"	SC 200
2-1/2"	SC 250
3"	SC 300
4"	SC 400

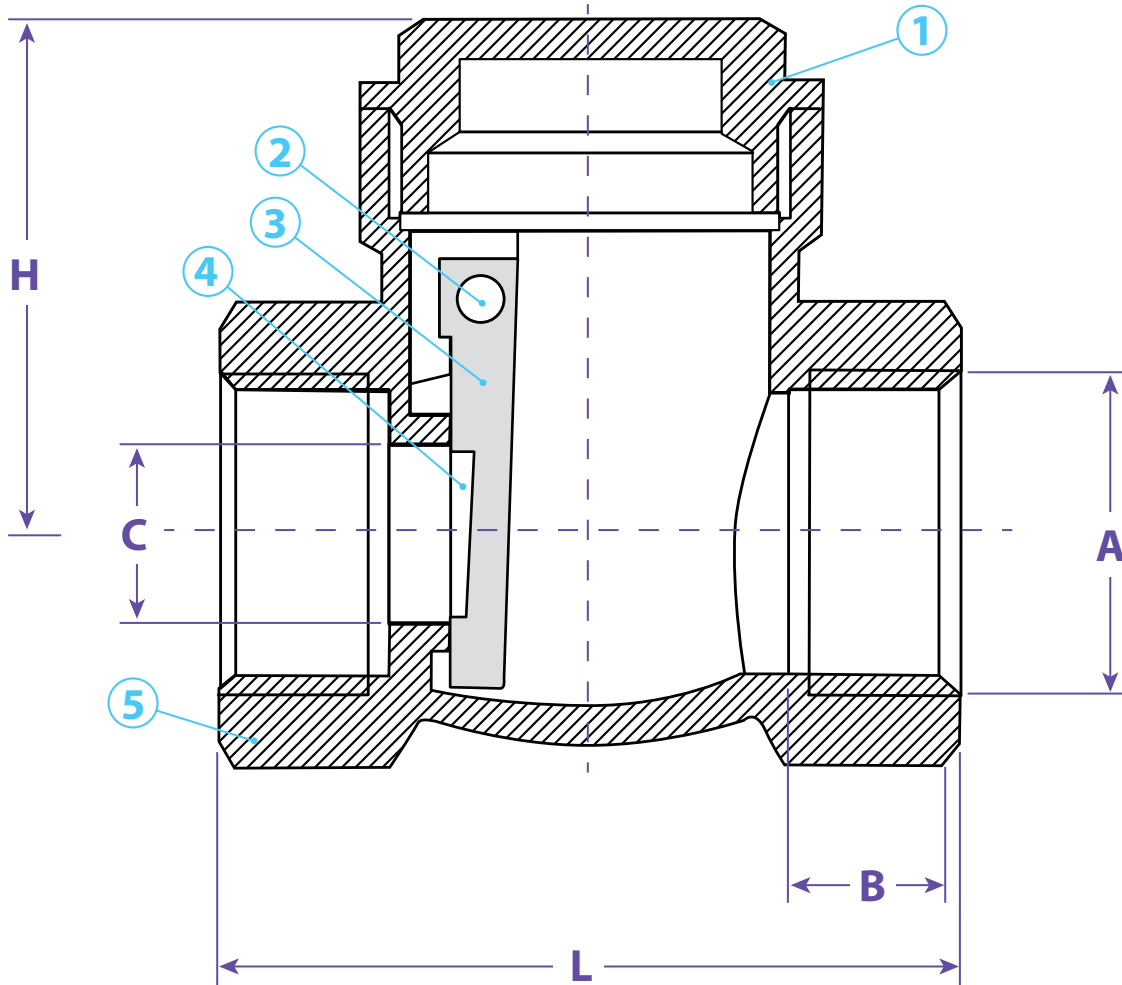

Dimensions						
Size	A	B	C	L	H	Part #
1/2"	1/2"	.39	.51	2.24	1.32	SC050
3/4"	3/4"	.51	.67	2.32	1.44	SC075
1"	1"	.51	.91	2.44	1.71	SC100
1-1/4"	1- 1/4"	.67	1.08	3.07	1.99	SC125
1-1/2"	1- 1/2"	.71	1.28	3.42	2.28	SC150
2"	2"	.94	1.65	4.01	2.52	SC200
2-1/2"	2- 1/2"	.79	1.85	5.12	3.19	SC300
3"	3"	.98	2.24	5.91	3.27	SC400
4"	4"	1.02	3.15	6.85	3.94	SC400

Nomenclature & Material		
No.	Description	Material
1	Bonnet	Brass
2	Plug	Brass
3	Pin	Brass
4	Disc	Brass
5	Body	Brass

TITLE **SWING CHECK VALVE**

**DISCLAIMER**

All drawings and specifications are subject to change without notice. Drawings represent general dimensions of our products. Seal Fast Inc. cannot guarantee the dimensions will exactly match those in the drawing. The drawing is the property of Seal Fast Inc. Copying or reproduction of this drawing is expressly prohibited.

MATERIAL

**BRASS**

**DRAWING NOT TO SCALE**

PART #

**SC...**